

A NEW VIEW







A NEW WAY OF LIFE

A very wise man once said, "There is a world out there, open a window and it's there."

So many times, we get caught behind closed doors that we forget there is always a window, ready to let light, love and laughter in. It is your eye to see a new world, a new view. It is also a way of letting the world know a lot about you. It lets the world see your style, your lifestyle and your taste.

This is the belief that lead us into making Aparna Venster; an environment - friendly product that is lead-free, recyclable with low heat transmission and an aesthetic appeal that matches your persona to the hilt. And the buck doesn't just stop there. We are the only company to provide you with profiles, reinforcements and windows, to make sure that your house always looks good.

THE APARNA ASSURANCE

Aparna Venster comes from the highly reputed Aparna Enterprises Ltd., an Aparna Group Company. With expertise in a wide range of building materials like Double Charged Polished Vitrified Tiles & Glazed Vitrified Tiles, Steel Sections, Ready Mix Concrete, Building Lifestyle Gated Communities, Housing Infrastructure and Real Estate Development, we understand the modern day house owners needs like no one else. That is why we bring you products that are a reflection of your lifestyle.







ENGINEERED TO FIT YOUR LIFESTYLE

Windows over the years have become more of a home accessory rather than just a constructive mandate. Be it constructing a skyscraper, a commercial complex, residential apartments, exotic villas or even renovating your existing house, Aparna Venster has always strived to add to the beauty of your building. With our state-of-the-art German extrusion equipment and precision engineering in every metre of uPVC window & door systems, we conform to the toughest European standards of manufacturing.

PROVIDING YOU WITH THE BEST

Aparna Venster uPVC window & door systems have been one among the preferred choices when it comes to upgrading your windows. With production facilities in Hyderabad, Bengaluru and Bidar, equipped with the latest technology, we provide you with end-to-end solutions for your home which include survey, design, fabrication, delivery, installation and post-sales service.





EXTRUSION

We make use of top-notch German extrusion lines and quality assurance laboratory equipment, certified by NABL accredited agencies to manufacture our profiles.



REINFORCEMENT

Our premium window & door systems come along with suitable galvanized steel reinforcements, which are manufactured at our metal forming plant. Furthermore, we also offer custom-made reinforcements with varied thickness, as per your requirements.





LAMINATION

With a wide range of colours and textures available, you can easily customise your window and door systems to match with the décor of the entire house. Lamination is done with German foil & hot melt PU adhesive.



FABRICATION

When it comes to fabrication, our trust lies in the technologically sound machinery from Germany that ensures high reliability and accuracy. The profiles are then reinforced with galvanised steel sections to help them withstand strong wind pressures.

NOT JUST A LIFESTYLE ACCESSORY

Change, they say, is always a good habit. For without it, we will never know the possibilities that surround us. The same goes for our uPVC window & door systems. It is never too late to replace your old doors and windows with our uPVC window & door systems which are a perfect combination of aesthetics and functionality.







SOUNDPROOF

- Cut noise levels up to 40 decibels, making them the perfect solution for your home and office



WEATHERPROOF

- Ideal for high-rise buildings, especially in coastal areas, which are exposed to strong winds, heavy rains and salty weather conditions



ECO-FRIENDLY

- Lead-free, consumes less power when extruded and are completely recyclable due to the presence of calcium zinc stabilizers



ENERGY EFFICIENT

- Multi-chambered sections come with unique double seal mechanisms that perfectly insulate your home against heat
- Saves up to 30% on AC power bills by providing you with high heat insulation capability, 2.2 times better than aluminium windows
- Materials used are self extinguishing in case of fire and their inherent strength does not allow them to alter even under extreme summer or winter temperatures



EASY MAINTENANCE

- Low-maintenance and do not require painting or other such activities as they do not rot, warp or corrode and are 100% termite proof
- Due to the nature of the materials used, these frames remain highly durable even after years of usage



AESTHETIC, PRACTICAL & SECURE

- Easily customisable to suit any configuration or dimension
- Can be laminated to enhance beauty
- Can be fitted with multi-point high security locks that can be screwed into the steel core of the window and door systems

TEXTURES
INSPIRED
BY NATURE



MAHAGONI



WALL NUT



GOLDEN OAK



DARK OAK



Many other captivating colour options are also available.





QUALITY
NEVER GOES
UNREWARDED







TYPES OF WINDOWS

• Casement window • Sliding window • Arch window • Special windows • Colored windows offer architectural design with suitably placed color handles and other hardware

Wide variety of window & door systems

• Colored and foiled windows • Even a single color or wood grain finish bestows very special and aesthetic look to a building • The harmonious mixture of color and wood grain structures achieve the ideal visual effect • The vivid wood grain structure looks and feels like natural wood

SALIENT FEATURES OF APARNA VENSTER, uPVC WINDOW & DOOR SYSTEMS

- We source the best in class raw materials to manufacture our window & door systems without compromising on cost and quality
- Our factory is equipped with completely automated compound mixer unit to produce the dry blend.
- To avoid physical contamination, we have a well-equipped Automation System from CMU to Extruder Hopper.
- Since our compound is superior, weathering tests have proved that our profiles resist discoloration.
- Our uPVC window & door systems come with thickness ranging between $2.2 \pm 0.2 \text{mm}$ and $2.8 \pm 0.2 \text{mm}$.
- Our in-house laboratory is equipped for testing raw materials & finished goods. Every batch will be tested for all the 18 parameters.
- Our uPVC window & door systems exhibit excellent impact & heat resistance.
- Our advanced lab conforms to the European standard specification, EN 12608:2003 and every uPVC system is manufactured according to this standard.
- Our QC and production teams continuously monitor the quality of the product 24x7.
- Our standard colour specified range is I >93, a -0.8 to -1.1, b 1.8 to 2.4.
- Our uPVC systems have great inner wall bonding, inside gloss and finish, which are much better than many others. And these properties make our uPVC systems much stronger.
- We have a batch identification printed on each main profile with manufacturer name, line number, date & time for any future assistance, if required.
- For transparency of quality testing, we carry out third party testing for our uPVC systems at reputed laboratories.
- Aparna Enterprises Ltd. is certified: ISO 9001-2015; OSHAS 18001-2007; ISO 14001-2015 & the product is certified for Restriction of Hazardous substances (ROHS).

V7 PROFILE DESIGNS - SLIDING

Sl. No.	Tool Name	Description
1	AP-101	Sliding Frame 2 - track
2	AP-102	Sliding Frame with Mesh Track
3	AP-103	Sliding Frame 3-Track
4	AP-104	Sliding Window Sash
5	AP-105	Sliding Door Sash
6	AP-106	Interlock
7	AP-108	Screen Sash for Window
8	AP-109	Screen Sash for Door
9	AP-110	Glazing Bead for SS (5-6 mm)
10	AP-111	Double Glazing Bead for SS (18 mm)
11	AP-112	Butt Profile
12	AP-113	Frame Coupling

V7 SERIES (7 Feet Height) ADVANTAGES

1. Lead-free window & door systems
2. Multi chamber window & door systems
3. Window & door systems sized to 60 mm width and height 52 mm
4. Wall thickness ranges from 2.2 to 2.5 mm which is superior to competitors
5. Equipped to produce 7 feet height doors
6. Backed by technology to offer great combination of window & door systems

V7 SLIDING SERIES

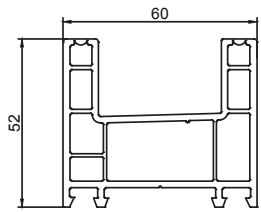

AP 101
SLIDING FRAME 2 TRACK

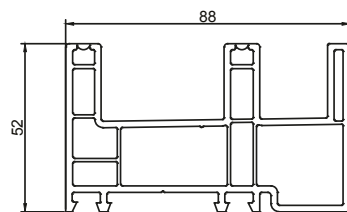

AP 102
SLIDING FRAME WITH MESH TRACK

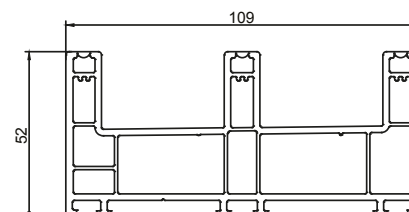

AP 103
SLIDING FRAME 3 TRACK

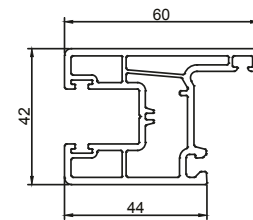

AP 104
SLIDING WINDOW SASH

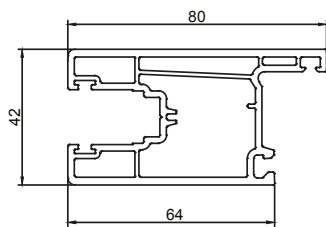

AP 105
SLIDING DOOR SASH

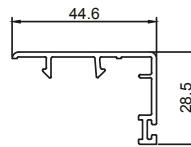

AP 106
INTERLOCK

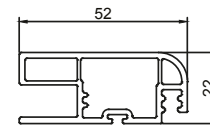

AP 108
SCREEN SASH FOR WINDOW

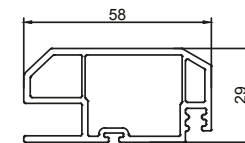

AP 109
SCREEN SASH FOR DOOR

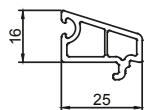

AP 110
GLAZING BEAD FOR SS (5-6 mm)

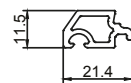

AP 111
DOUBLE GLAZING BEAD FOR SS (18 mm)

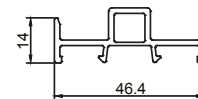

AP 112
BUTT PROFILE

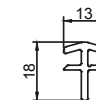

AP 113
FRAME COUPLING

All dimensions are in mm.

V7 PROFILE DESIGNS - CASEMENT

Sl. No.	Tool Name	Description
1	AP-201	Casement Window Outer Frame
2	AP-202	Casement Door Outer Frame
3	AP-203	Universal Profile
4	AP-204	Casement Window Sash
5	AP-205	Casement Door Sash
6	AP-206	T - Mullion
7	AP-207	Z - Mullion
8	AP-208	Fly - Mullion
9	AP-209	Glazing Bead for CS (8-10 mm)
10	AP-210	Glazing Bead for CS (5-6 mm)
11	AP-211	Double Glazing Bead for CS (22-24 mm)
12	AP-212	Upstand Bead

V7 CASEMENT SERIES

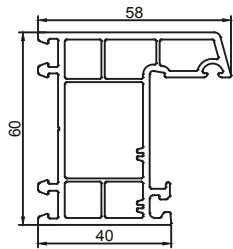

AP 201
CASEMENT WINDOW OUTER FRAME

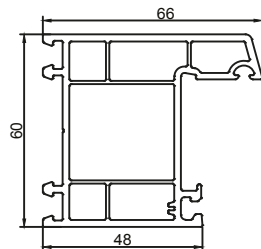

AP 202
CASEMENT DOOR OUTER FRAME

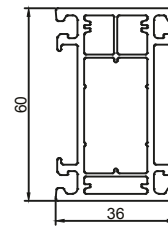

AP 203
UNIVERSAL PROFILE

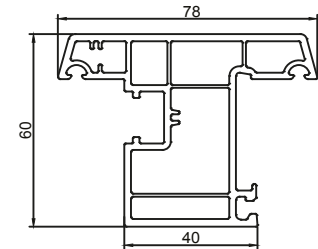

AP 204
CASEMENT WINDOW SASH

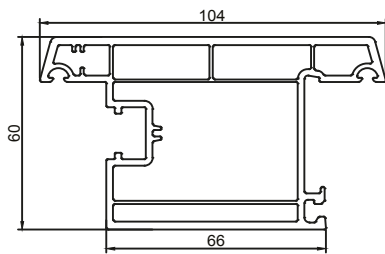

AP 205
CASEMENT DOOR SASH

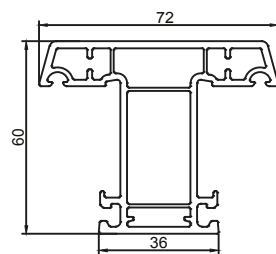

AP 206
T - MULLION

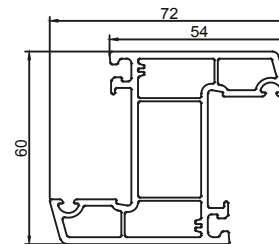

AP 207
Z - MULLION

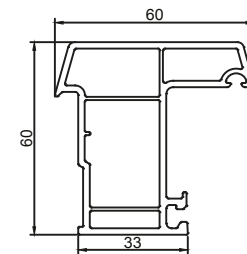

AP 208
FLY - MULLION

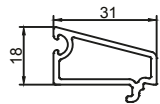

AP 209
GLAZING BEAD FOR CS (8-10 mm)

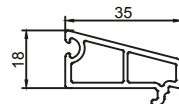

AP 210
GLAZING BEAD FOR CS (5-6 mm)

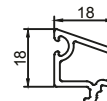

AP 211
DOUBLE GLAZING BEAD FOR CS (22-24 mm)

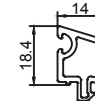

AP 212
UPSTAND BEAD

All dimensions are in mm.

V10 PROFILE DESIGNS - SLIDING

Sl. No.	Tool Name	Description
1	AP-301	Sliding Frame 2-Track
2	AP-302	Sliding Frame 3-Track
3	AP-303	Sliding Frame 4-Track
4	AP-305	Sliding Door Sash
5	AP-306	Interlock
6	AP-309	Glazing Bead for SS (10-12 mm)
7	AP-310	Glazing Bead for SS (6 mm)
8	AP-311	Double Glazing Bead for SS (18 mm)
9	AP-312	Butt Profile
10	AP-313	Mesh Lock Profile

V10 SERIES (10 Feet Height) ADVANTAGES

1. Lead-free window & door systems
2. Multi chamber window & door systems
3. Window & door systems sized to 65 mm width and height 58 mm
4. 'A' grade window & door system comes with a wall thickness of 2.8 mm which is superior to competitors
5. Equipped to provide 10 feet height doors
6. The 4 Track window & door system is manufactured to accommodate 8 panels with 10 meters width and 10 feet height doors
7. Equipped to provide partition doors with a width of more than 10 meters
8. Backed by technology to provide doors of 4 meters width and 7 feet height with only 2 panels

Apama Venster leads the window & door systems segment with the advantage of manufacturing equipment from Germany. Our in-house Roll Forming (GI reinforcement), Glass cutting, Arch bending and foiling equipment enable us to provide end-to-end solutions.

V10 SLIDING SERIES

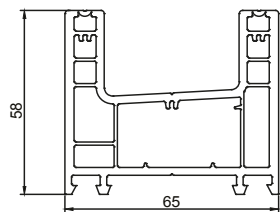

AP 301
SLIDING FRAME 2-TRACK

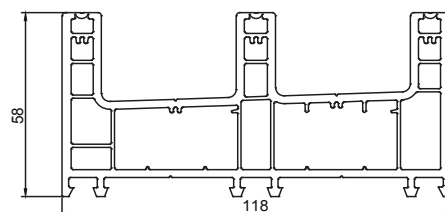

AP 302
SLIDING FRAME 3-TRACK

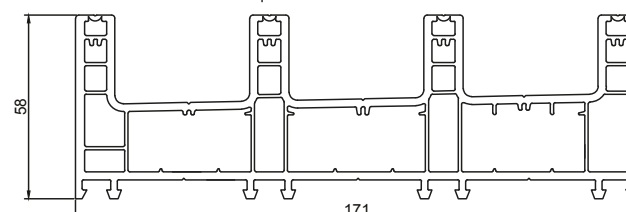

AP 303
SLIDING FRAME 4-TRACK

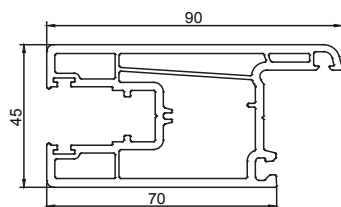

AP 305
SLIDING DOOR SASH

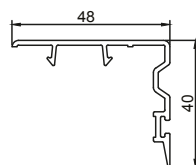

AP 306
INTERLOCK

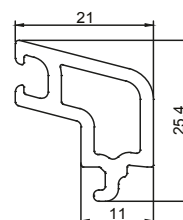

AP 309
GLAZING BEAD FOR SS (10-12 mm)

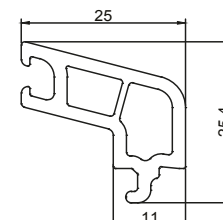

AP 310
GLAZING BEAD FOR SS (6 mm)

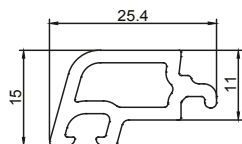

AP 311
DOUBLE GLAZING BEAD FOR SS (18 mm)

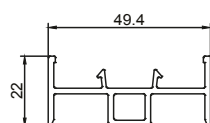

AP 312
BUTT PROFILE

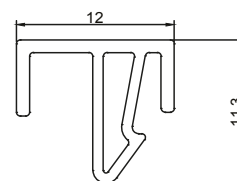

AP 313
MESH LOCK PROFILE

All dimensions are in mm.



APARNA ENTERPRISES LTD.

An Aparna Group Company

8-2-293/82/A, Plot No. 1214, Road No. 60,
Jubilee Hills, Hyderabad - 500 033, T.G. India.

Tel: +91 40 23606245 / 23357761

Fax: +91 40 23606246

Email: info@aparnavenster.com

www.aparnavenster.com

CIN: U51109TG1994PLC018950

For any queries, suggestions or complaints,
please call on +91 40 23357761 or
email us at customercare@aparnavenster.com or
write to us at the above corporate office address.